

WWSR

Wheel weighing system ramp installation

QUICK START GUIDE

ENGLISH

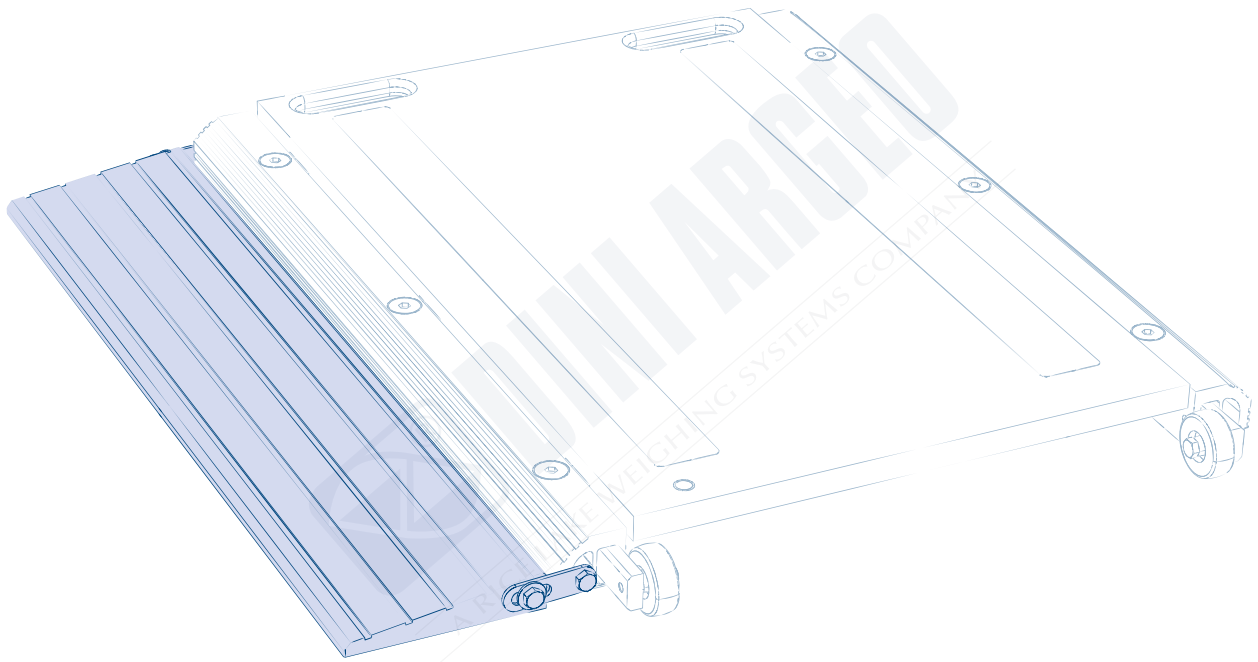

Copyright

© Dini Argeo. All rights reserved.

Dini Argeo® is a registered trademark.

Dini Argeo owns the copyright for the contents of this document (including artwork, illustrations, photographs, and written material). You may not copy, reproduce, modify, republish, or distribute any material from this document without permission.

All other brand or product names within this publication are trademarks or registered trademarks of their respective companies.

Dini Argeo is a Rice Lake Weighing Systems Company.

Kit parts

The WWSBR kit includes a ramp and mounting hardware

X1

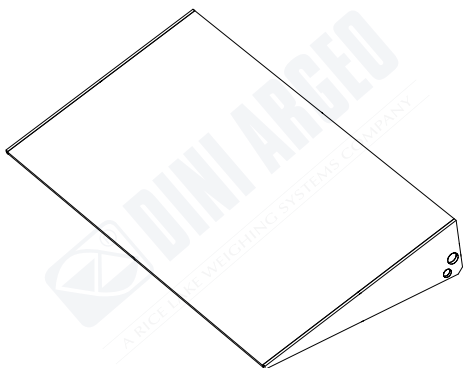

X2

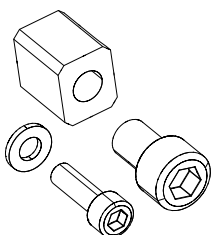

The WWSCR, WWSE and WWSDR kits include a ramp and mounting hardware

X1

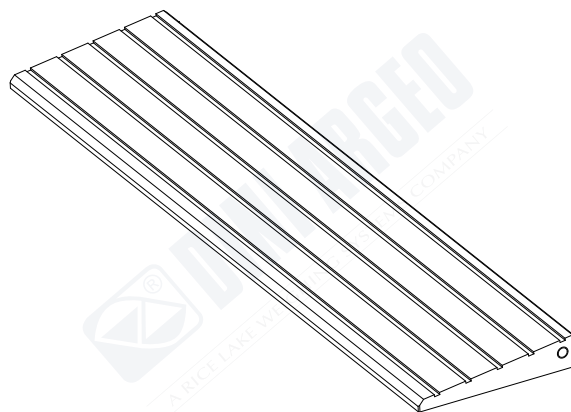

X4

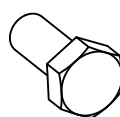

X2

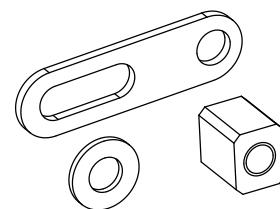

Technical specifications

	WWSBR	WWSCR	WWSE	WWSDR
Compatibility	WWSB	WWSC	WWSE	WWSD and WWSF
Dimensions (L x W x H)	400 x 200 x 54 mm	500 x 150 x 30 mm	700 x 150 x 30 mm	900 x 150 x 30 mm
Weight	3.5 kg	4.5 kg	6.2 kg	7.8 kg
Material	Aluminium	Aluminium	Aluminium	Aluminium
Max load	8,000 kg	15,000 kg	15,000 kg	20,000 kg

Installation



Adhere to all safety warnings and specifications in the WWS manual when installing ramps.



Wear safety shoes during ramp and WWS operation.



Danger of crushing hands and feet.

WWSBR INSTALLATION

1. Position the WWSB on the ground with the screen facing up.
2. Insert the coupling into the outer most WWSB frame slot.

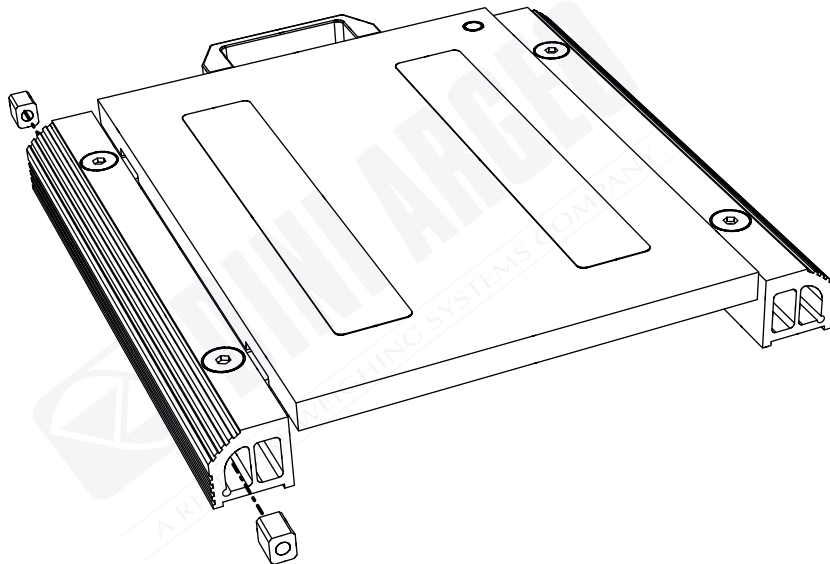

3. Position ramp over long edge of WWSB.
4. Align mounting holes in ramp with holes in coupling and WWSB frame.

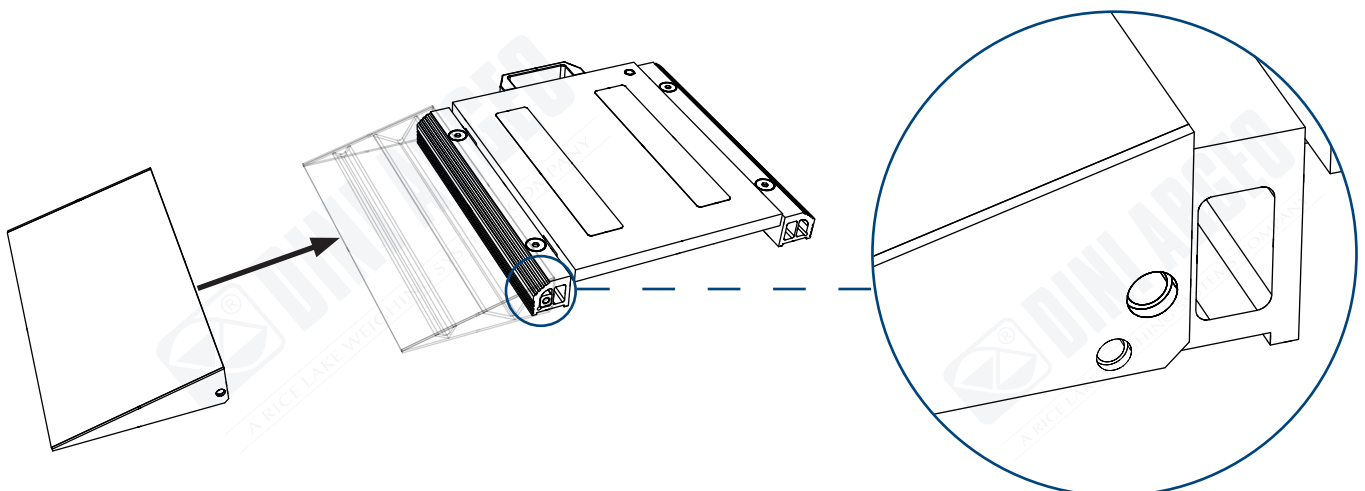

5. Attach the ramp to coupling using the provided large diameter bolt.
6. Attach the ramp to the WWSB frame using the provided narrow bolt and washer.
7. Tighten bolts to 18 N m.

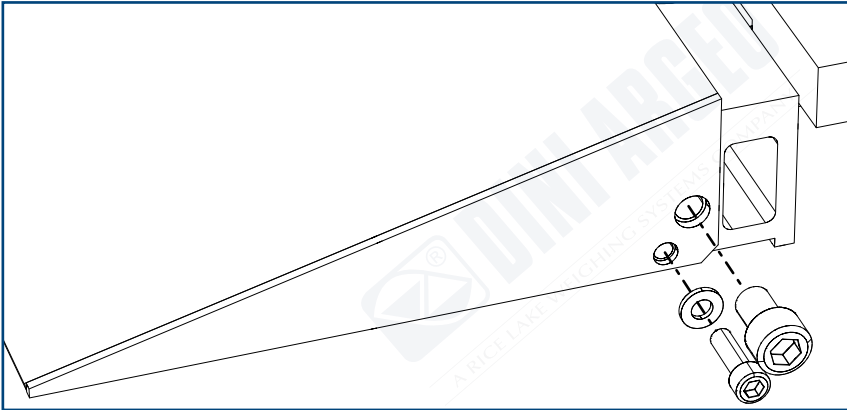

8. Repeat steps 4 through 7 on opposite side of ramp.
9. If installing a second ramp, repeat procedure for opposite side of WWSB.

WWSCR, WWSER or WWSDR INSTALLATION

1. Position the WWS (WWSC, WWSER, WWSD, or WWSF) on the ground with the screen facing up and ramp on the ground with the ridges facing up.
2. Position the long side of the ramp adjacent to the long side of the WWS.

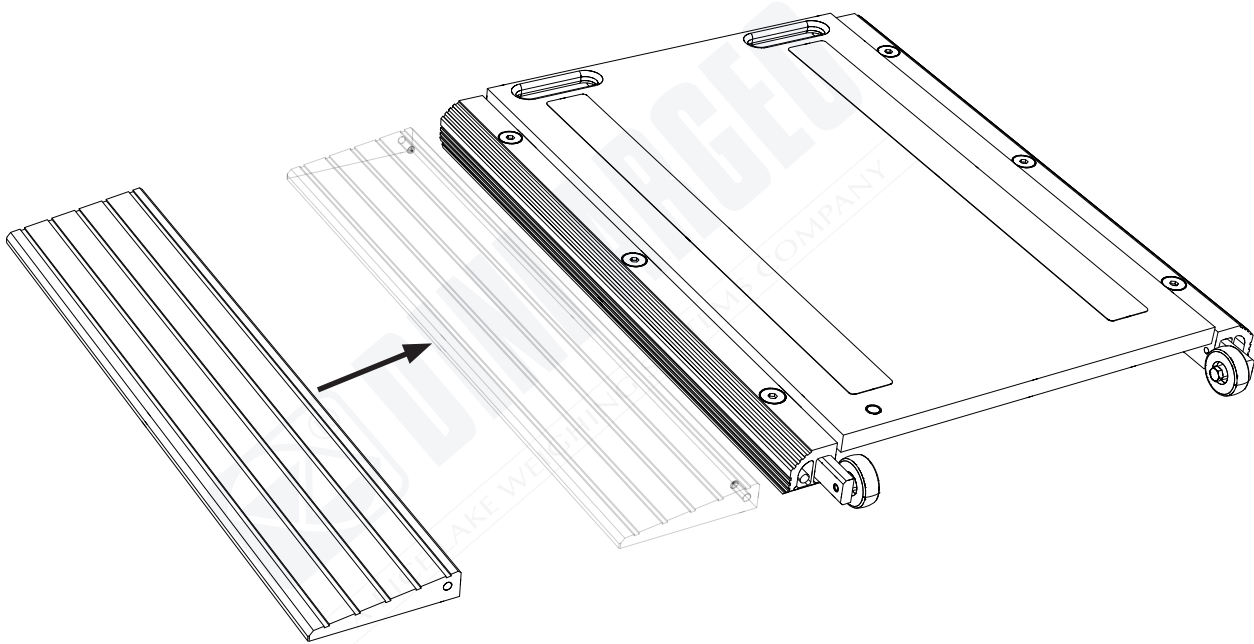

3. Insert the coupling into the WWS frame slot adjacent to wheel.

4. Attach bracket to coupling with provided bolt.

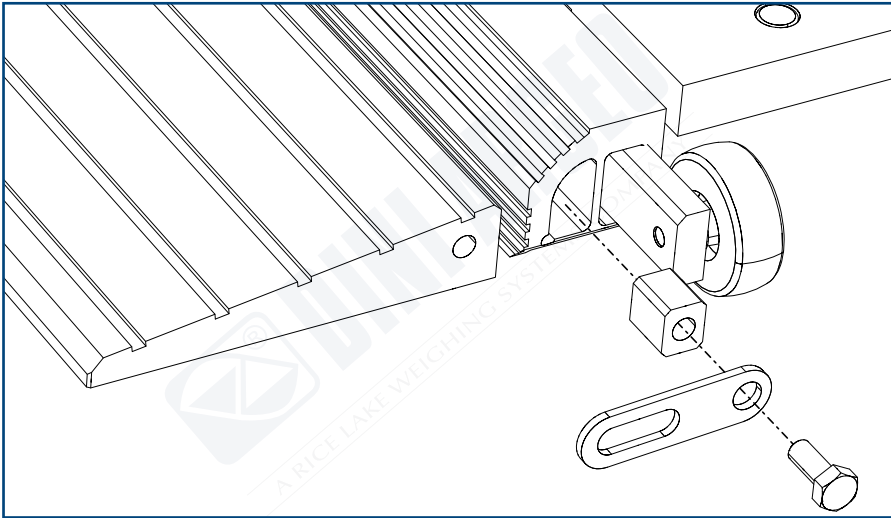

5. Attach bracket to ramp using provided washer and bolt.

6. Tighten bolts to 18 N m.

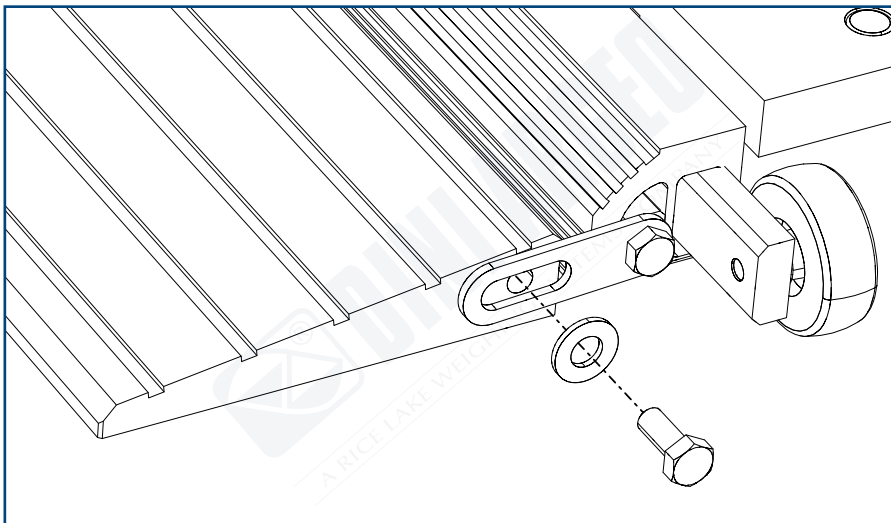

7. Repeat steps 2 through 6 on opposite side of ramp.

8. If installing a second ramp, repeat procedure for opposite side of WWS.

Folding Ramps (WWSCR, WWSER, or WWSDR)

1. Loosen ramp bolts on both sides of WWS.

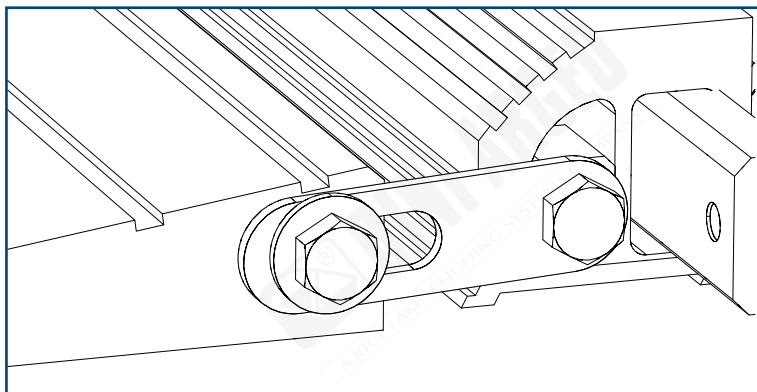

2. Fold ramps on top of WWS.
3. Tighten bolts to 18 N m.
4. Reverse procedure to unfold ramps.

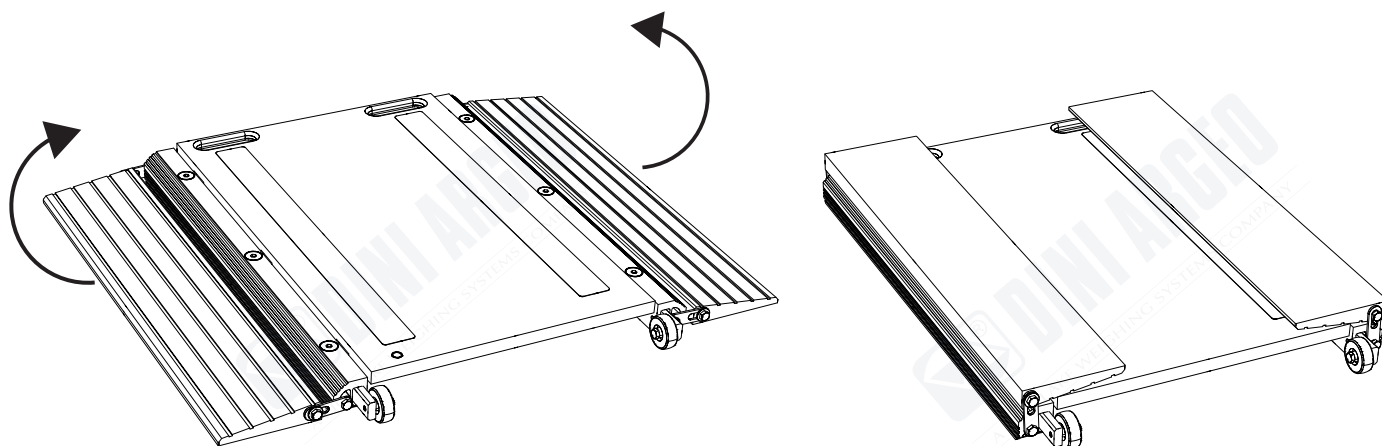

Notes

Warnings



Attention danger of crushing hands



Attention danger of crushing feet



A RICE LAKE WEIGHING SYSTEMS COMPANY

HEAD OFFICE

Via Della Fisica, 20
41042 Spezzano di Fiorano, Modena - Italy
Tel. +39 0536 843418 - Fax +39 0536 843521

SERVICE ASSISTANCE

Via Dell'Elettronica, 15
41042 Spezzano di Fiorano, Modena - Italy
Tel. +39 0536 921784 - Fax +39 0536 926654

www.diniargeo.com © Dini Argeo

Authorised service centre stamp

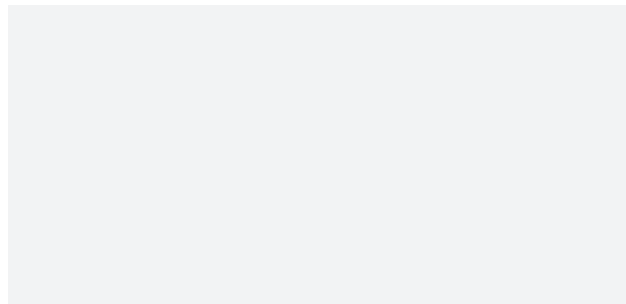

The information in this document is approximate and can be subject to variations without prior notice by Dini Argeo, with respect of the norms in force. The official technical data is available in the updated version on the www.diniargeo.com website or by contacting the Dini Argeo Customer Service.